

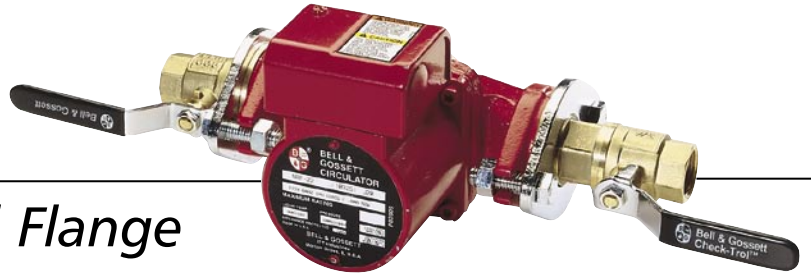

Check-Trol™

Isolation Flow Control Flange



Three features in one valve.

Check-Trol is the solution for circulator installations. Installing a Check-Trol on the discharge of the circulator gives you the features of a Flow Control Valve, Isolation Valve and Companion Flange. Another advantage of the Check-Trol is the minimal pressure drop, especially when compared to the losses that can be experienced when a check valve is installed internal to the circulator.

The Check-Trol flanges are packaged with an isolation flange of the same size to create a pair. Capscrews and nuts are included.

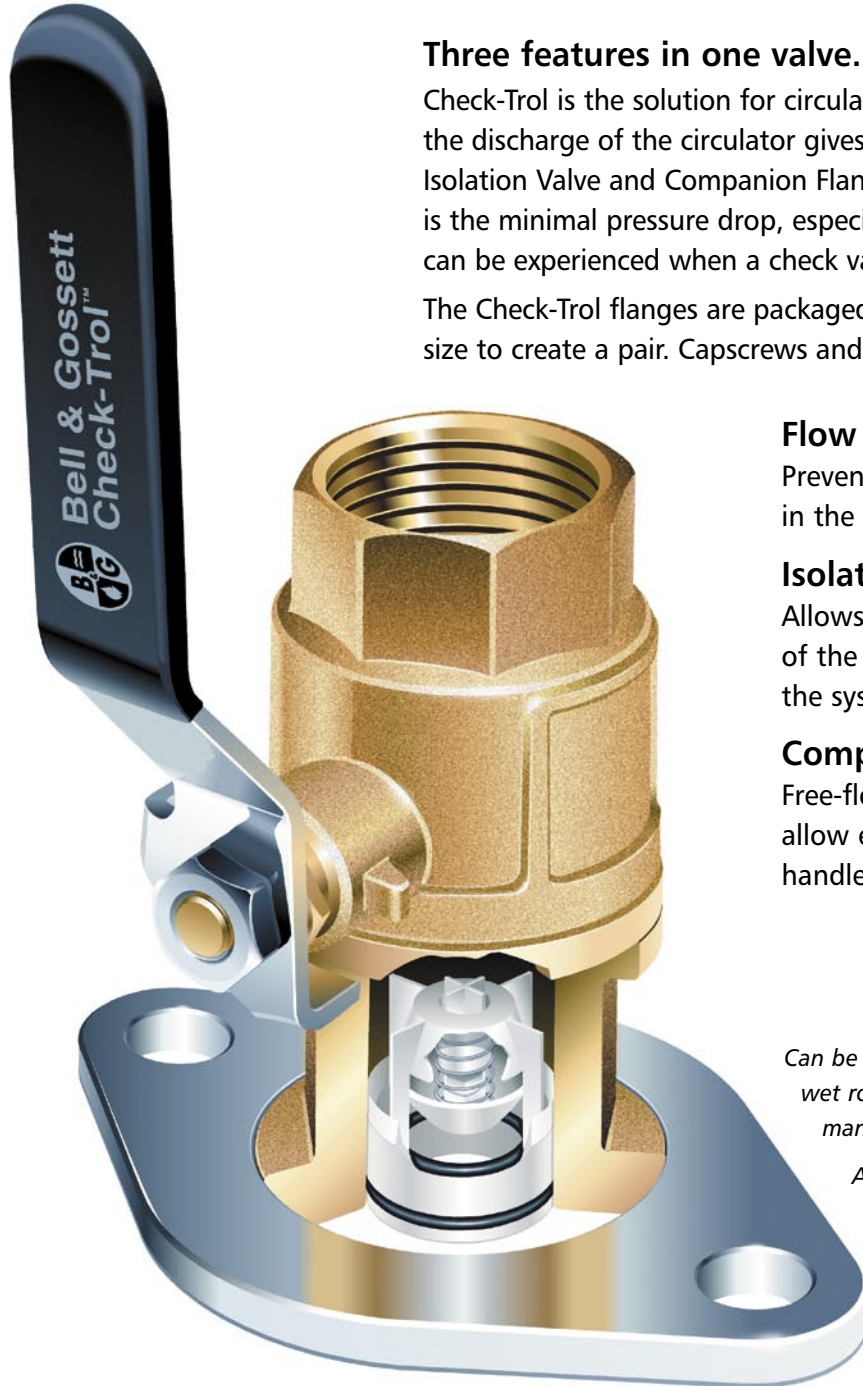

Flow Control Valve

Prevents gravity circulation and flow in the wrong direction.

Isolation Valve

Allows for servicing or replacement of the circulator without draining the system.

Companion Flange

Free-floating companion flanges allow easy alignment for optimal handle positioning.

Can be used with most circulators, including NRF/NBF/SSF wet rotors, Series PLs, 100, HV, PR and LR, and other manufacturers' pumps.

Available sizes: 3/4", 1", 1-1/4", 1-1/2" NPT and Sweat.

Patent Pending

Bell & Gossett®



ITT Industries
Engineered for life



Check-Trol™ Isolation Flow Control Flange

Description

The Check-Trol flange is a combination isolation valve, flow control valve, and companion flange for circulators. The ball valve allows the circulator to be removed from the system without draining the system. The internal spring check prevents gravity circulation. Free floating companion flange makes pump installation a snap.

Operating Data

Maximum working pressure 150 psi (10 bar)
 Maximum operating temperature..... 200°F (93°C)

Materials of Construction

Valve Body Brass
 Flange Chrome Plated Steel
 Ball Chrome Plated Brass
 Packing Teflon®*
 Seat Ring Teflon
 Stem Brass
 Spring Check Nitrile, Acetal, Stainless Steel

* Teflon is a registered trademark of E.I. du Pont de Nemours and Company.

Dimensions and Weights

Model No.	Size Inches	Model	Use with Following Circulators	Dimensions – Inches (MM)					Approx. Shpg. Wt. Lbs. (Kg)
				A	B	B1**	C	D	
101231	3/4" NPT x Flange	CTF -3/4	NRF/NBF/SSF Wet Rotors	3/4" NPT	3" (76)	2-3/8" (60)	2-1/8" (54)	4" (102)	3.6 (1.6)
101232	1" NPT x Flange	CTF -1	Series PL-30, PL-36, PL-55	1" NPT	3-13/16" (97)	2-3/4" (70)	2-5/16" (59)	4" (102)	4.3 (2.0)
101233	1-1/4" NPT x Flange	CTF -1-1/4	Series 100, PR, and LR	1-1/4" NPT	4-3/4" (120)	2-3/16" (81)	2-5/8" (67)	5" (127)	6.0 (2.7)
101245	1-1/2" NPT x Flange	CTF -1-1/2		1-1/2" NPT	4-13/16" (122)	3-1/4" (83)	2-5/8" (67)	5" (127)	6.5 (2.9)
101234	1" NPT - HV x Flange	CTF-1 HV	PL-45, PL-50, and Series HV	1" NPT	2-3/4" (70)	2-3/4" (70)	2-5/16" (59)	4" (102)	4.3 (2.0)
101235	1-1/4" NPT-HV x Flange	CTF -1-1/4 HV		1-1/4" NPT	4-3/4" (120)	3-3/16" (81)	2-5/8" (67)	5" (127)	6.0 (2.7)
101246	1-1/2" NPT-HV x Flange	CTF -1-1/2 HV		1-1/2" NPT	4-13/16" (122)	3-1/4" (83)	2-5/8" (67)	5" (127)	6.5 (2.9)
101236	3/4" SWT x Flange	CTFS -3/4	NRF/NBF/SSF Wet Rotors	3/4" SWT	3-5/16" (84)	2-19/32" (66)	2-1/8" (54)	4" (102)	3.6 (1.6)
101237	1" SWT x Flange	CTFS -1	Series PL-30, PL-36, PL-55	1" SWT	4-1/4" (107)	3-11/64" (81)	2-5/16" (59)	4" (102)	4.3 (2.0)
101238	1-1/4" SWT x Flange	CTFS -1-1/4	Series 100, PR, and LR	1-1/4" SWT	5-3/8" (136)	3-13/16" (97)	2-5/8" (67)	5" (127)	6.1 (2.8)
101247	1-1/2" SWT x Flange	CTFS -1-1/2		1-1/2" SWT	5-1/2" (140)	3-15/16" (100)	2-5/8" (67)	5" (127)	6.5 (2.9)
101239	1" SWT-HV x Flange	CTFS -1 HV	PL-45, PL-50, and Series HV	1" SWT	4-1/4" (107)	3-11/64" (81)	2-5/16" (59)	4" (102)	4.3 (2.0)
101240	1-1/4" SWT-HV x Flange	CTFS -1-1/4 HV		1-1/4" SWT	5-3/8" (136)	3-13/16" (97)	2-5/8" (67)	5" (127)	6.1 (2.8)
101248	1-1/2" SWT-HV x Flange	CTFS -1-1/2 HV		1-1/2" SWT	5-1/2" (140)	3-15/16" (100)	2-5/8" (67)	5" (127)	6.5 (2.9)

Dimensions and weights are approximate and subject to change. Contact factory for certified dimensions. Check-Trol flange is sold with an isolation flange as a pair.

** B₁ Dimension is overall length of isolation flange. The part numbers and shipping weights are for one Check-Trol flange and one isolation flange, capscrews and nuts.

Typical Specifications

Furnish and install on plans _____ " NPT/Sweat x Flange Check-Trol flange on the pump discharge. The Check-Trol flange will prevent gravity circulation and flow in the wrong direction. When closed, it will provide positive shut-off. The mating flange shall be free floating allowing it to rotate eliminating the need to align the bolt holes of the flanges when installing to the piping system. The Check-Trol flange shall be constructed with a brass body, chrome plated brass ball and flange, zinc plated handle, and Teflon packing and seat ring and a non-ferrous check. The Check-Trol flange shall be ITT Industries – Bell & Gossett or equal.

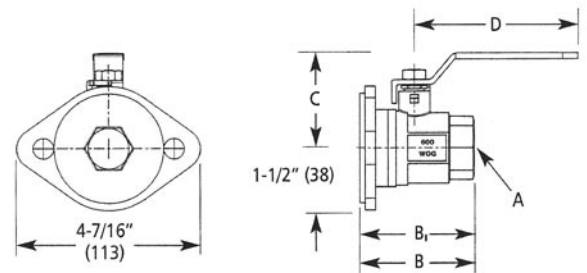

Patent Pending

USA
 Bell & Gossett
 8200 N. Austin Avenue
 Morton Grove, IL 60053
 Phone: 847/966-3700
 FAX: 847/966-9052
 www.bellgossett.com



INTL.
 Bell & Gossett / Export Dept.
 8200 N. Austin Avenue
 Morton Grove, IL 60053
 Phone: 847/966-3700
 FAX: 847/966-8366
 www.bellgossett.com

CANADA
 Fluid Products Canada
 55 Royal Road
 Guelph, Ontario,
 N1H 1T1, Canada
 Phone: 519/821-1900
 www.ittpc.ca

Bell & Gossett



ITT Industries
 Engineered for life